

East Sussex County Council Planning Committee 14 February 2018

Page 1

WD/796/CM

Polegate Yard, Summerhill Lane, Hailsham

Page 2

WD/796/CM
Polegate Yard, Summerhill Lane, Hailsham

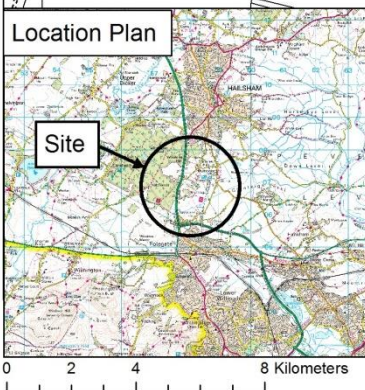

Rupert Clubb, BEng (Hons) CEng MICE, Director of Communities, Economy and Transport, East Sussex County Council

Reproduced from the Ordnance Survey mapping with the permission of the Controller of Her Majesty's Stationery Office © Crown Copyright. Unauthorised reproduction infringes Crown copyright and may lead to prosecution or civil proceedings. East Sussex County Council

WD/796/CM
Polegate Yard, Summerhill Lane, Hailsham



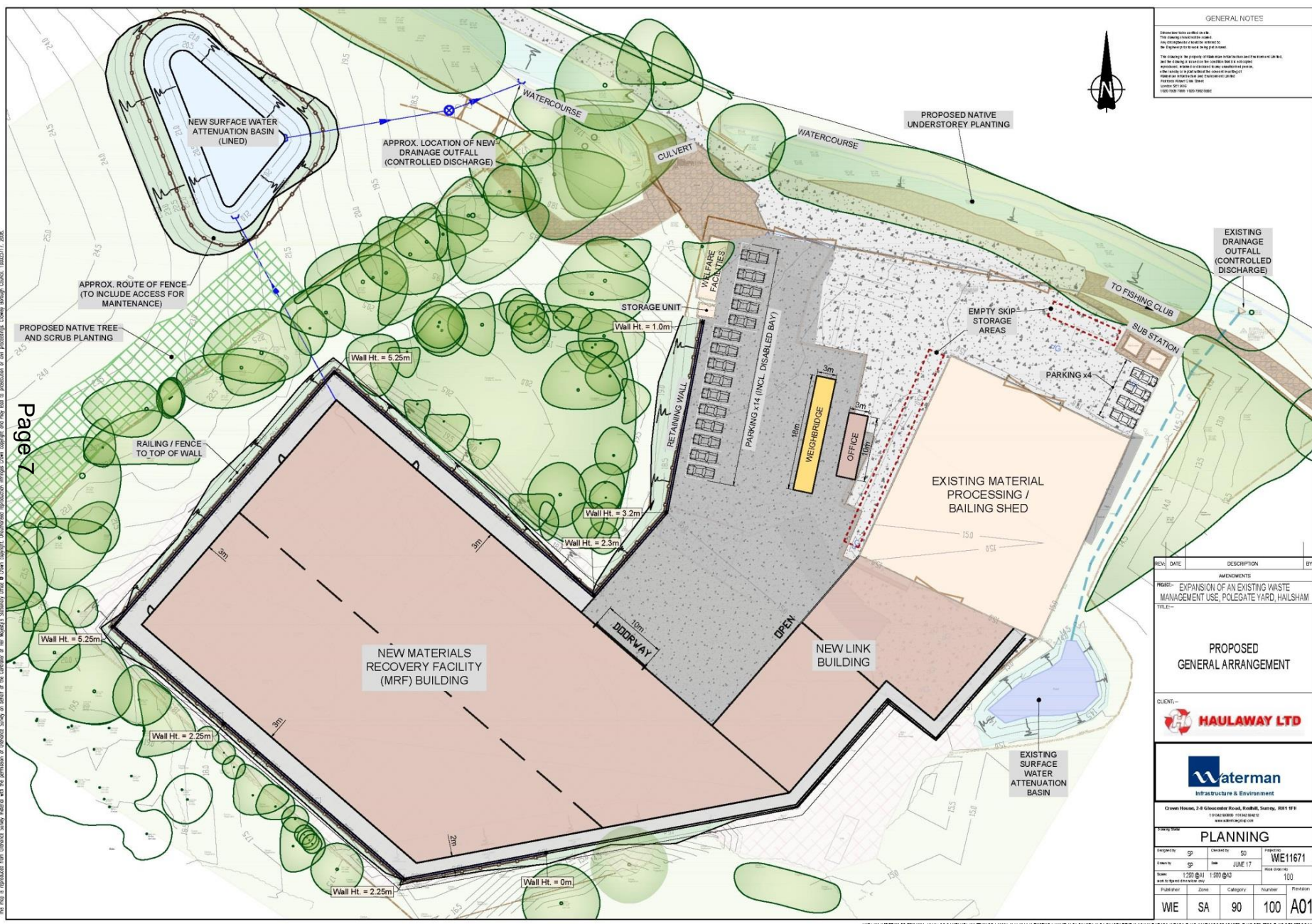

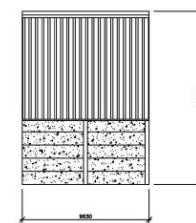
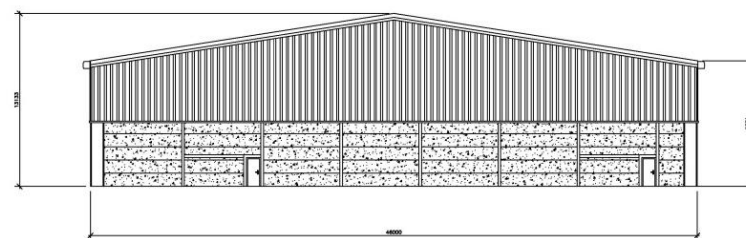
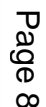
[illegible]

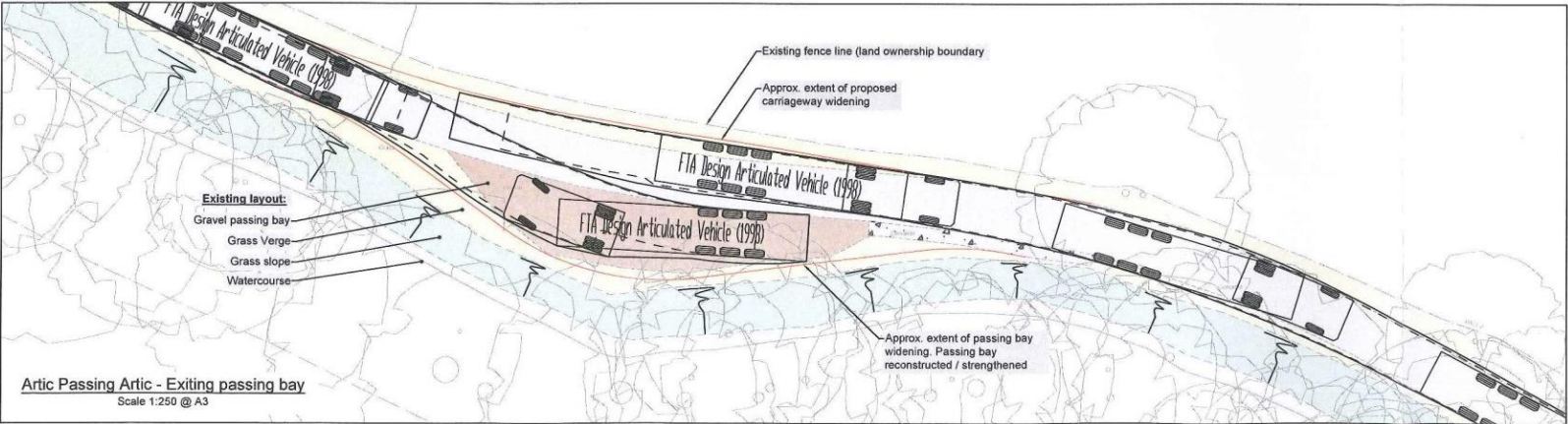
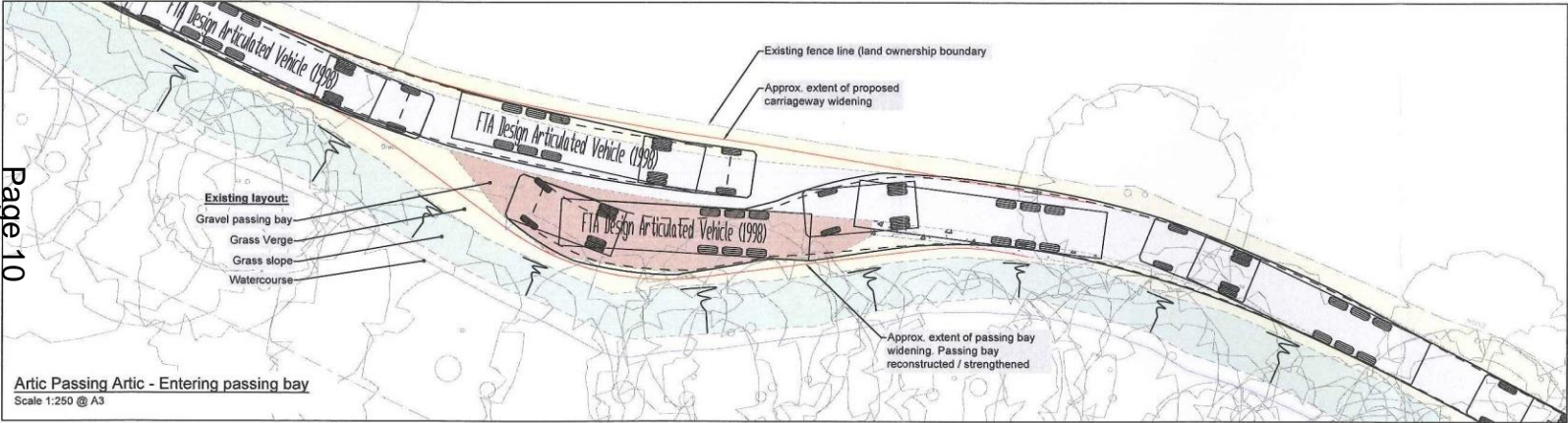
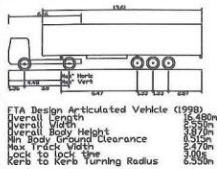
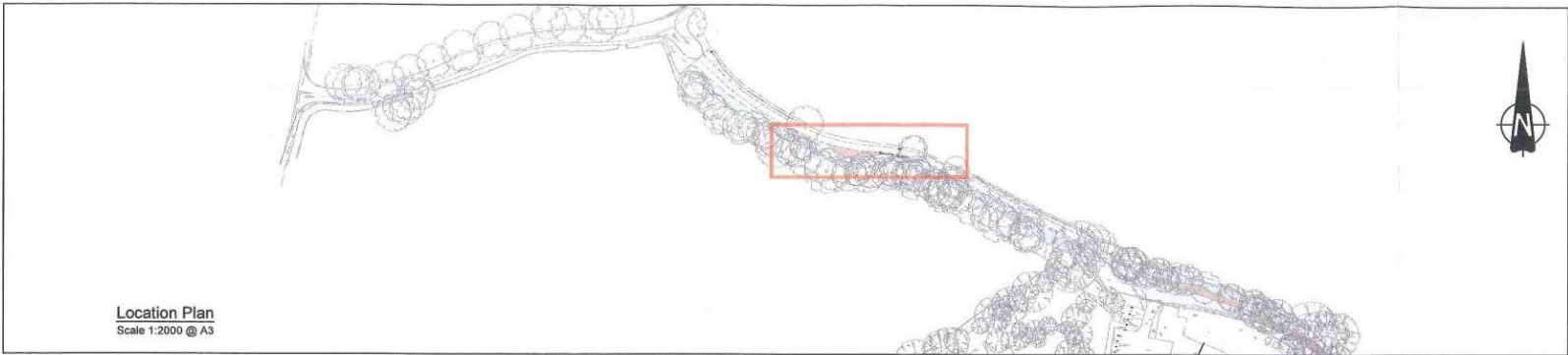

REVISED FIRST ISSUE				SP
Rev	Date	Description	By	

Project		POLEGATE YARD PHASE 2		
Title		VEHICLE TRACKING ACCESS ROAD PASSING BAY		
Client		HAULWAY LTD		



PRELIMINARY				
Drawn by	SP	Checked by	SD	Project No
Drawn by	SP	Checked by	SD	11671
Scale @ A3	1:250 @A3			
Author	Drawn	Checked	Number	Revision
WE	SA	05	0003	A01

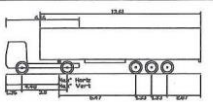
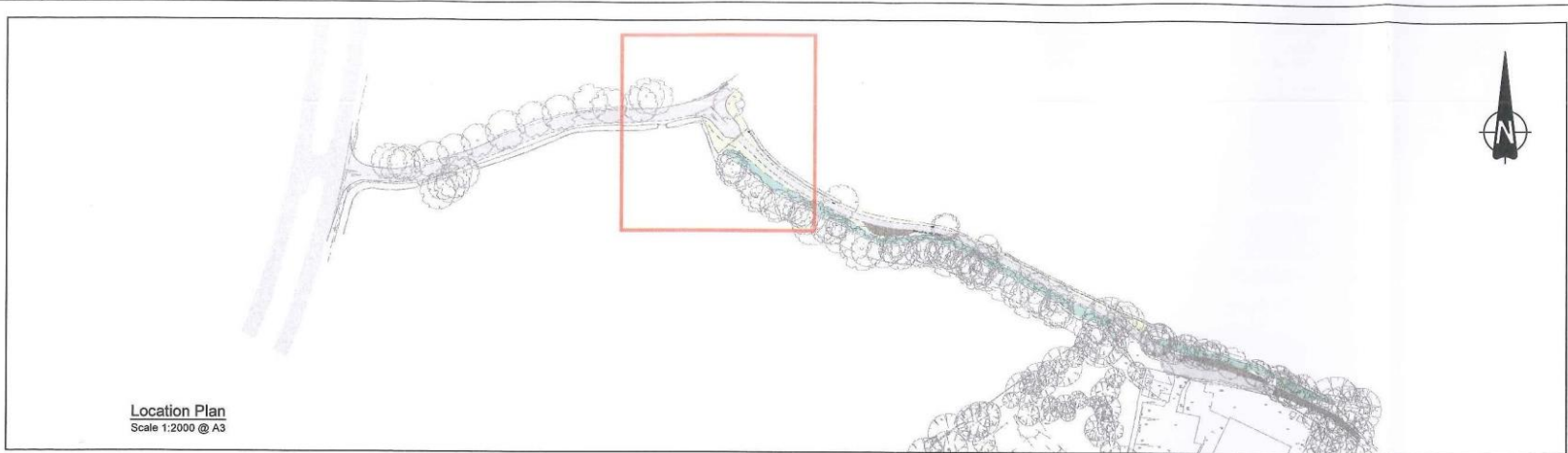

FTA Design Articulated Vehicle (1979)	
Overall Length	12.0m
Overall Width	2.5m
Overall Body Height	3.0m
Min Spd. Ground Clearance	1.0m
Max Trac. Width	2.5m
Lock to lock the Hags to Kerb Turning Radius	2.5m

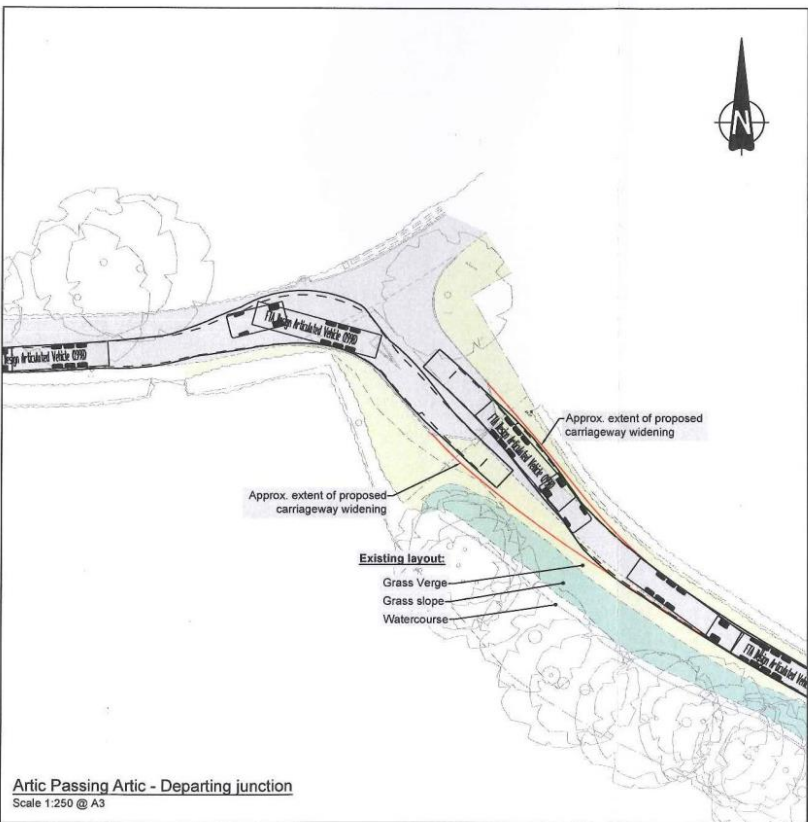
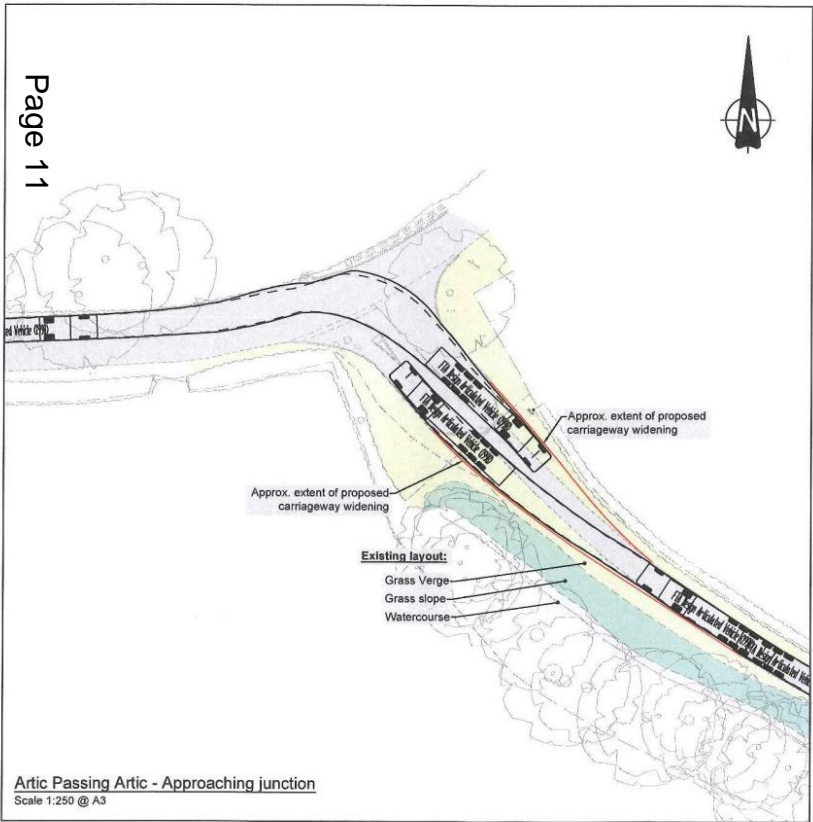

AD	16.06.17	FIRST ISSUE	SP
Rev	Date	Description	By

Amendments	
------------	--

Project: POLEGATE YARD PHASE 2

Title: VEHICLE TRACKING
SUMMER HILL LANE / ACCESS RD
JUNCTION

Client: HAULWAY LTD



Craven House 2-8 Gloucester Road Reading RG1 1TH
(01494) 404040 • 01494 404041
mail@waterman.co.uk www.waterman.co.uk

Drawing Status: PRELIMINARY

Drawn by: SP	Checked by: SO	Project No: 11671
Drawn by: SP	Date: 16.06.17	

Scale @ A1: 1:250 @ A3

Publication: WE	Date: SA	Category: 05	Revision: 0004	Revision: A01
-----------------	----------	--------------	----------------	---------------

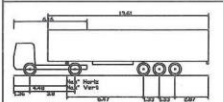
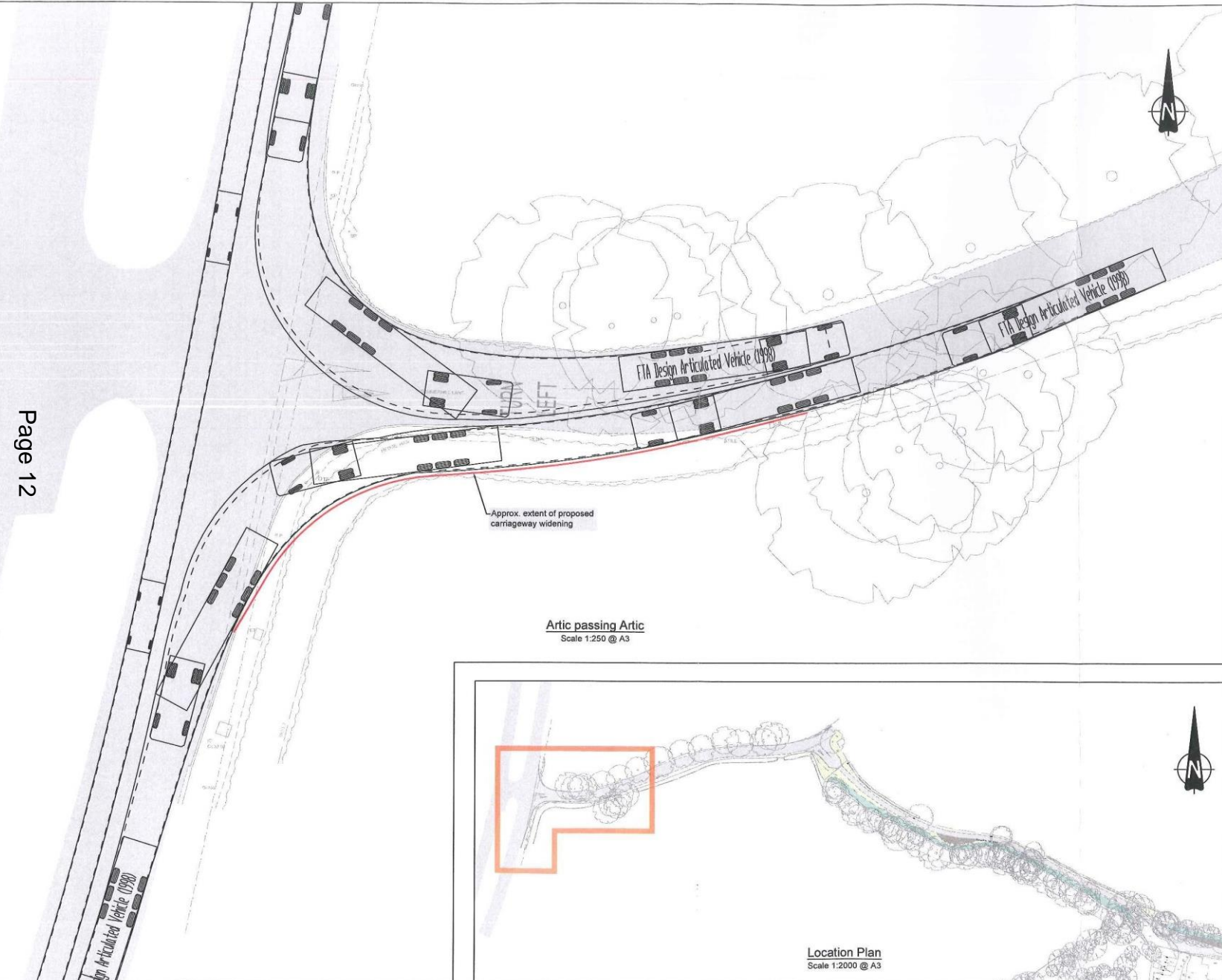

FTA Design Articulated Vehicle (1999)
Overall Length 13.00m
Overall Width 2.55m
Overall Body Height 3.00m
Min Body Ground Clearance 0.50m
Max Track Width 2.55m
Lock to lock time 4.00s
Kerb to Kerb Turning Radius 20.00m



Utility 4x4 (LVB) (2006)
Overall Length 5.10m
Overall Width 1.70m
Overall Body Height 1.70m
Min Body Ground Clearance 0.25m
Track Width 1.70m
Lock to lock time 4.00s
Kerb to Kerb Turning Radius 7.54m

Artic passing Artic
Scale 1:250 @ A3

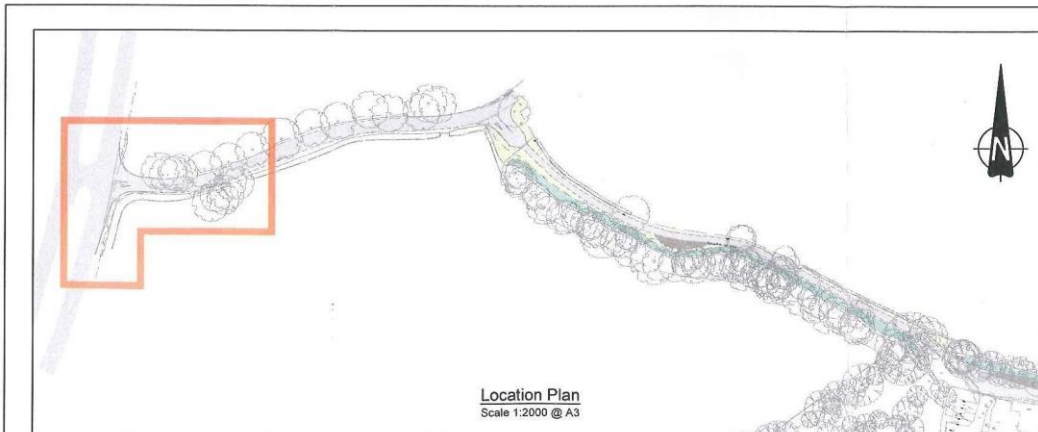

Location Plan
Scale 1:2000 @ A3

REV		DATE	DESCRIPTION	BY
A01		18.06.17	FIRST ISSUE	SP
Amendments				
Project POLEGATE YARD PHASE 2				
Title VEHICLE TRACKING A22 / SUMMER HILL LANE JUNCTION				
Client HAULWAY LTD				
Crown House 2-8 Gloucester Road Rodhill Surrey RM1 1FN Tel: 0181 606 1000 Fax: 0181 606 1001 info@watermangroup.com www.watermangroup.com				
Drawing Status PRELIMINARY				
Designed by SP	Checked by SO	Project No 11671		
Drawn by SP	Date 18.06.17	Computer File No		
Scale 0:1	Scale in North arrow pointing 1:250 @ A3	Computer File No		
Author	Draw	Check	Number	Revised
WE	SA	05	0005	A01

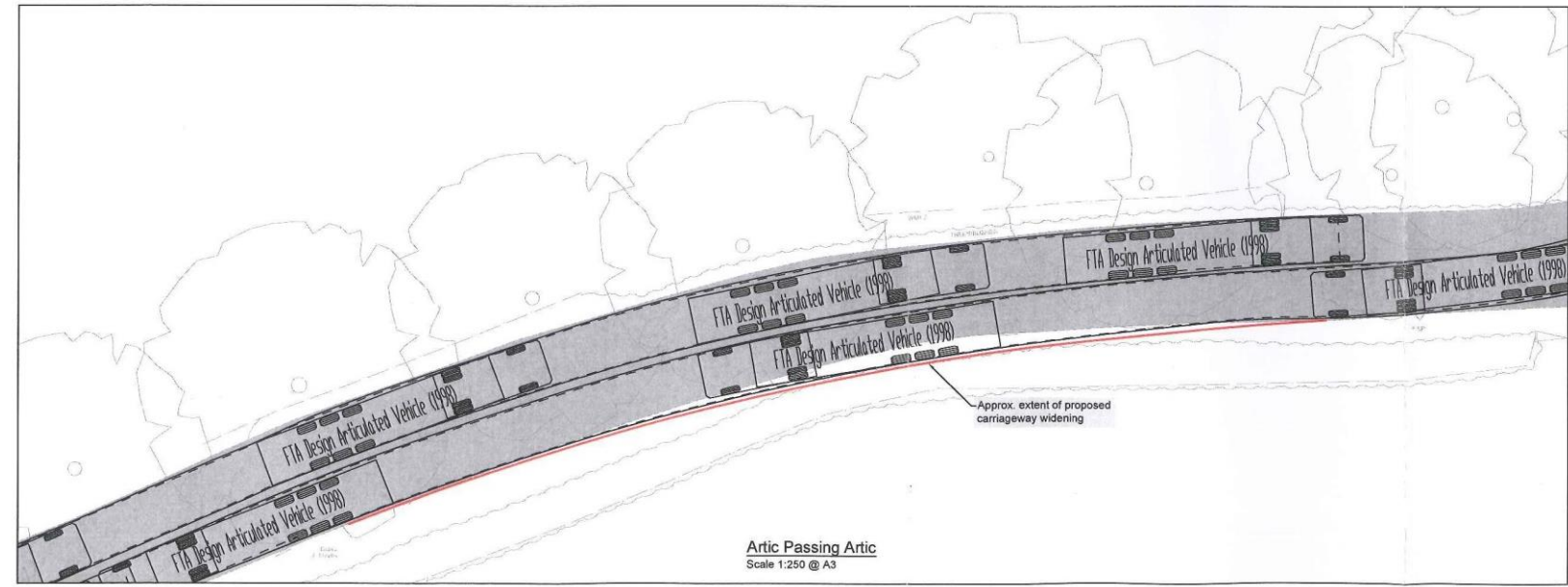

FTA Design Articulated Vehicle (1998)	
Overall Length	18.50m
Overall Width	2.55m
Min Body Height	3.50m
Min Body Ground Clearance	1.00m
Max Frame Width	2.55m
Lock to Lock Line	2.00m
Kerb to Kerb Turning Radius	2.50m

Rev	Date	Description	By
A01	16.06.17	FIRST ISSUE	SP

Project		POLEGATE YARD PHASE 2
Title		VEHICLE TRACKING SUMMER HILL LANE BEND
Client		HAULWAY LTD

Crown House 2-8 Gloucester Road Radford Surrey RH11 1RH
181242 80000 12011 and 12011
www.waterman.co.uk

Working Status

Designed by	SP	Checked by	SO	Project No.	11671
Drawn by	SP	Date	16.06.17	Calculator File No.	

Scale 1:250 @ A3

Author	Date	Category	Number	Revision
WE	SA	05	0006	A01









































WD/796/CM

Polegate Yard, Summerhill Lane, Hailsham

Traffic Regulation Order: Cradle Hill Community Primary School, Lexden Drive, Seaford

Page 35

Proposed parking and waiting restrictions in order to improve road safety in the vicinity of Cradle Hill Primary School.

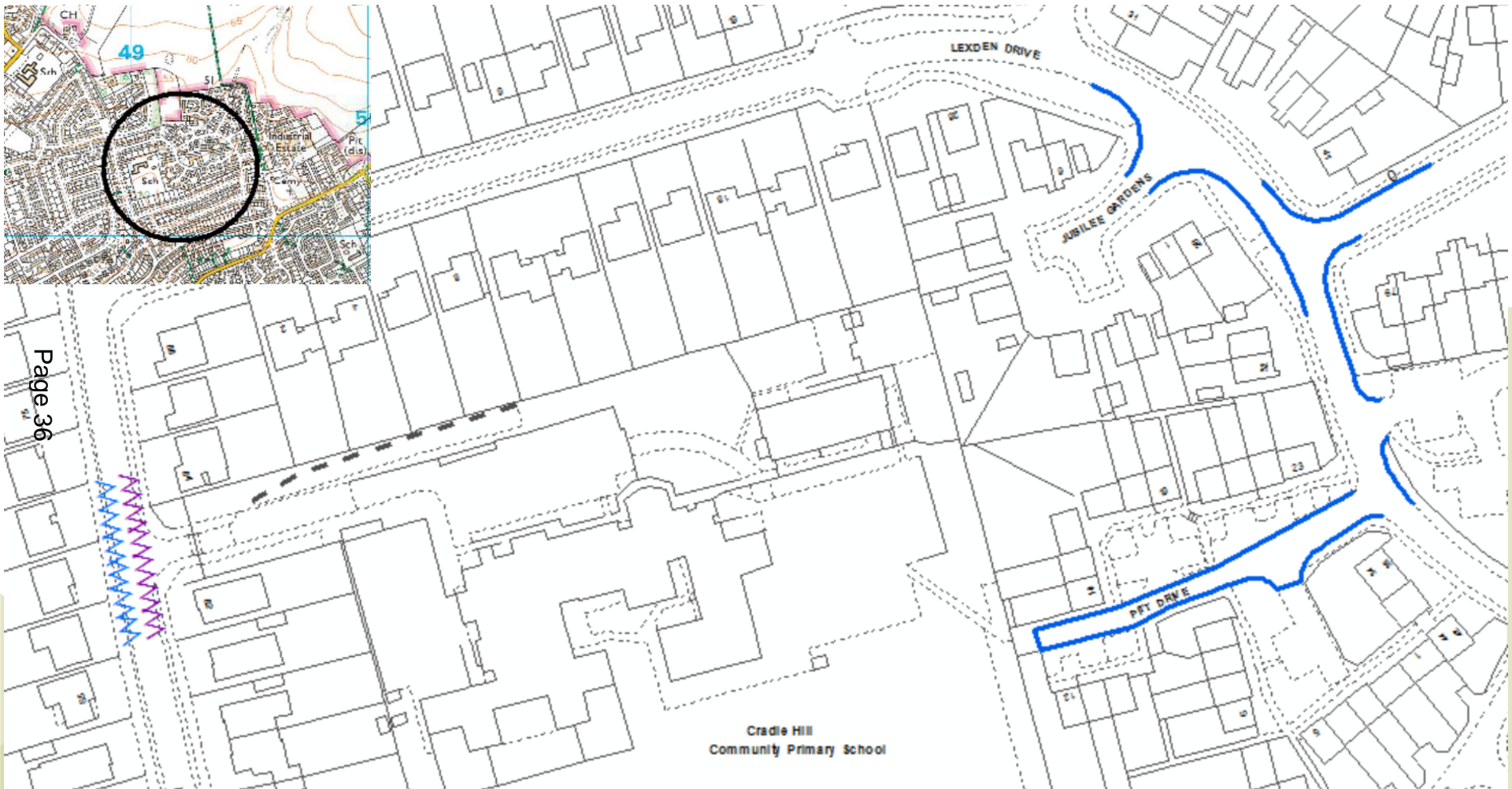

Page 36



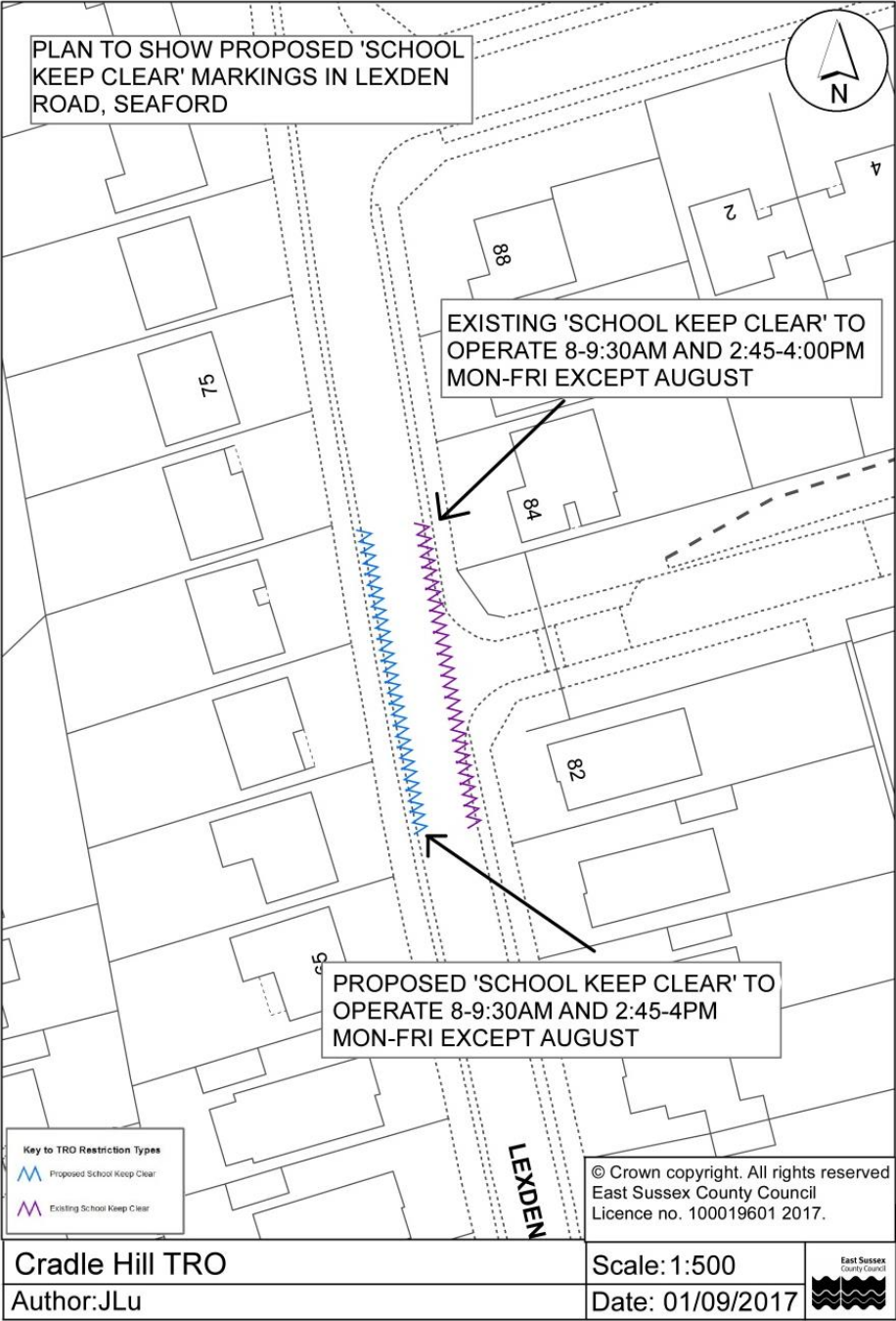



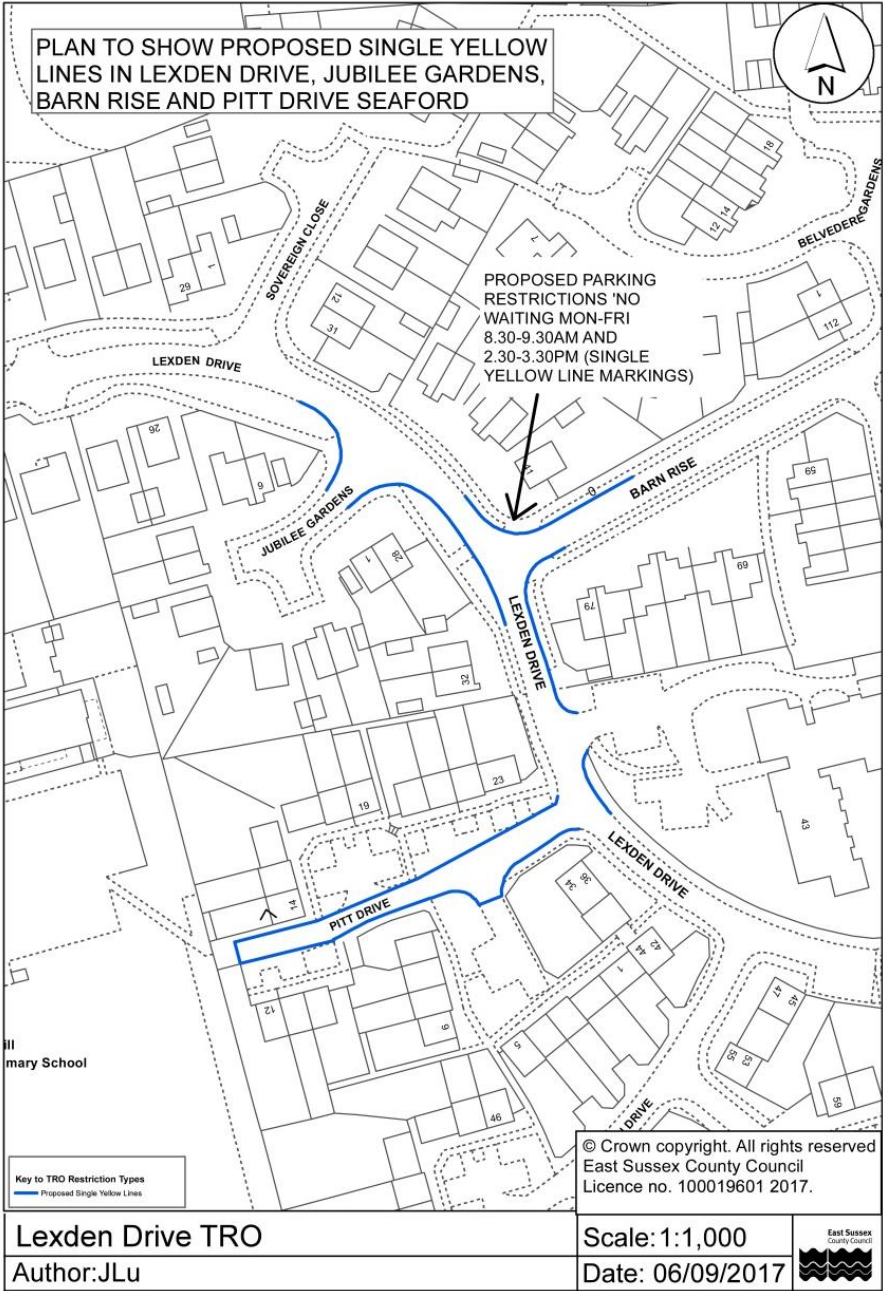



Page 41



Page 42



Traffic Regulation Order: Cradle Hill Community Primary School, Lexden Drive, Seaford

Page 44

Proposed parking and waiting restrictions in order to improve road safety in the vicinity of Cradle Hill Primary School.

Traffic Regulation Order: Eastbourne Town Centre Improvement Scheme (ETCIS)

Page 45

Proposed 20 MPH zone, bus lanes, parking and prescribed routes to facilitate the implementation of the ETCIS



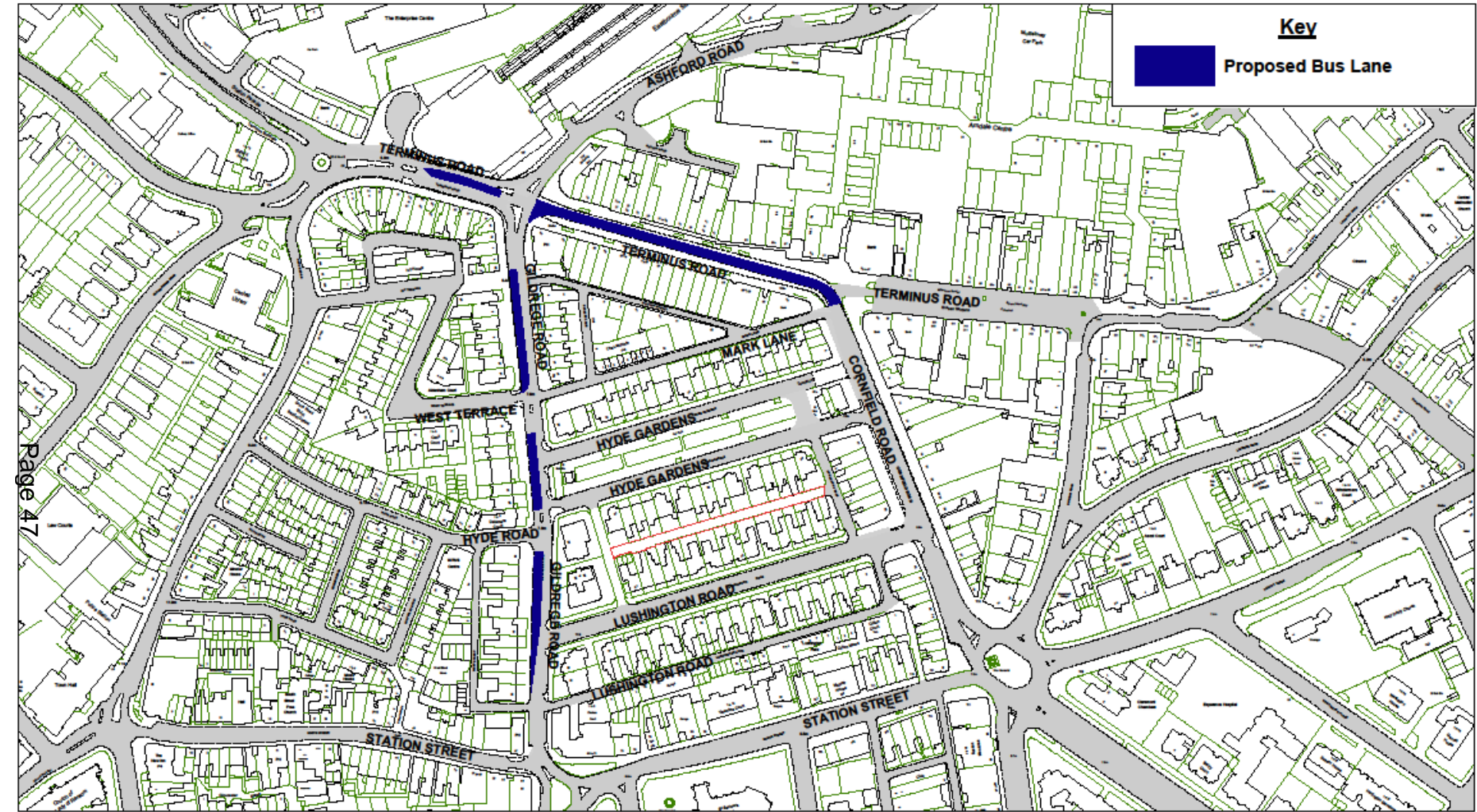

East Sussex
County Council



This map is reproduced from Ordnance Survey material with the permission of Ordnance Survey on behalf of the Controller of Her Majesty's Stationery Office © Crown Copyright. Unauthorised reproduction infringes Crown copyright and may lead to prosecution or civil proceedings.
East Sussex County Council
Licence No: 100019801-2017

Gildredege Road, Terminus Road,
Confield Road and South Street Area
Proposed Bus Lanest

SCALE

DATE

DRAWING No.

DRAWN BY





Proposed Bus Lane/Stand – Northern Point- Gildredge Road







Page 51

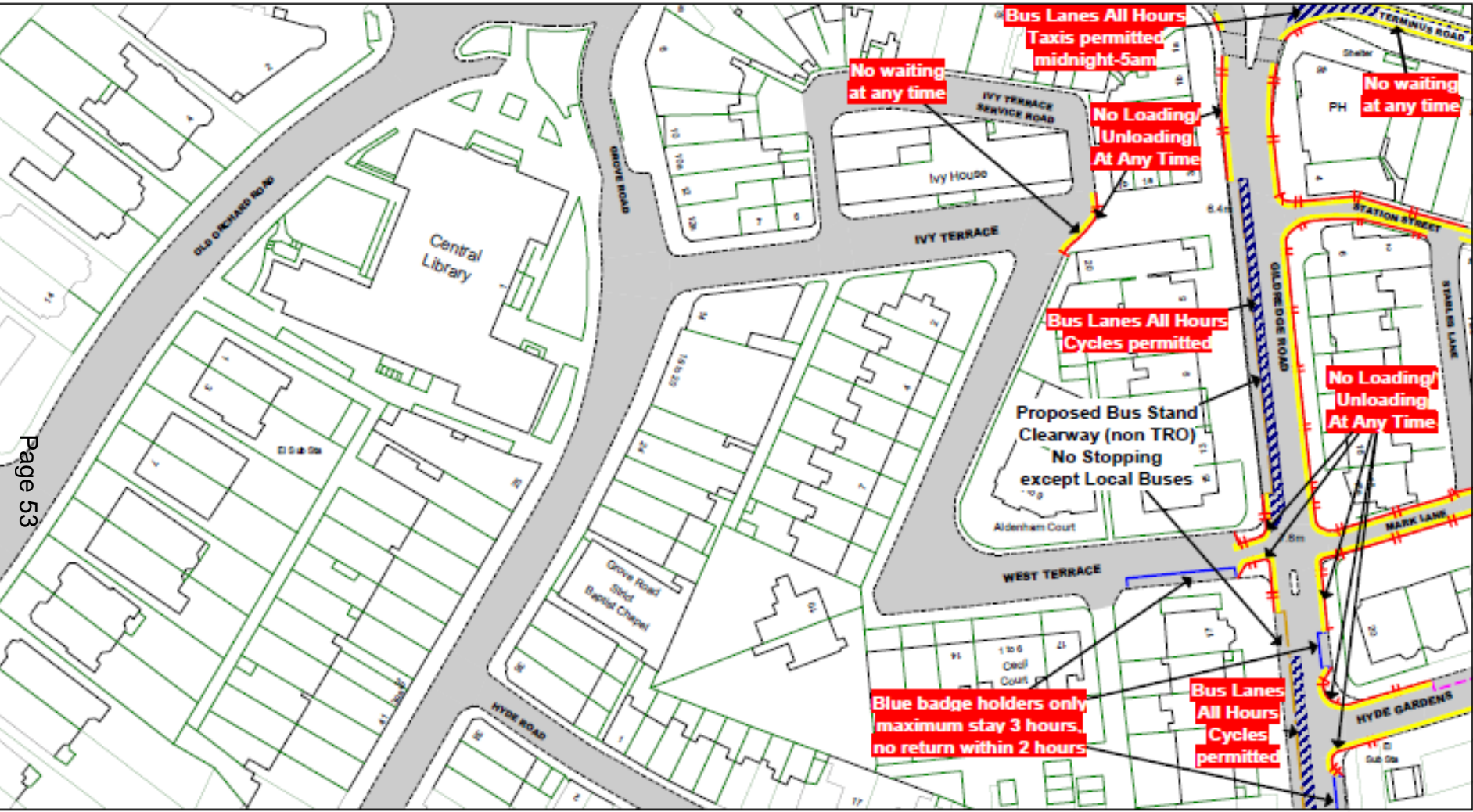

Page 52



Page 53



East Sussex County Council

The East Sussex (Eastbourne Town Centre Improvement Scheme) (Parking and Waiting) Order 201x

Key to Labels

ABCD	Permanent TRO restriction
ABCD	Proposed TRO restriction
ABCD	Non TRO item

Key to TRO Restriction Types

Yellow line	No Waiting at Any Time
Red line with cross-ticks	No Loading at Any Time
Blue line with cross-ticks	Permit Holders Only
Blue line with cross-ticks and dots	Permit Holder or Pay and Display
Blue line with cross-ticks and dots	Disabled Badge Holders Only
Blue line with cross-ticks and dots	Disabled Badge Holders Only
Blue line with cross-ticks and dots	Loading/Unloading Only
Blue line with cross-ticks and dots	Taxi Only

Key to Non TRO Items

Blue line with cross-ticks and dots	Loading/Unloading Only and Taxi Only
Blue line with cross-ticks and dots	Bus Lane
Blue line with cross-ticks and dots	Pedestrian Crossing (controlled area)
Blue line with cross-ticks and dots	Pedestrian Crossing Point
Blue line with cross-ticks and dots	Bus Stop/Stand Clearway

Adjacent Map Tile

OG176
OH175
OH177
OI176

W N E S

SCALE: 1 : 1000

DATE: 31/10/2017

Tile Ref: OH176 Revision: 0

© Crown copyright. All rights reserved
East Sussex County Council
Licence No. 100019501 2017

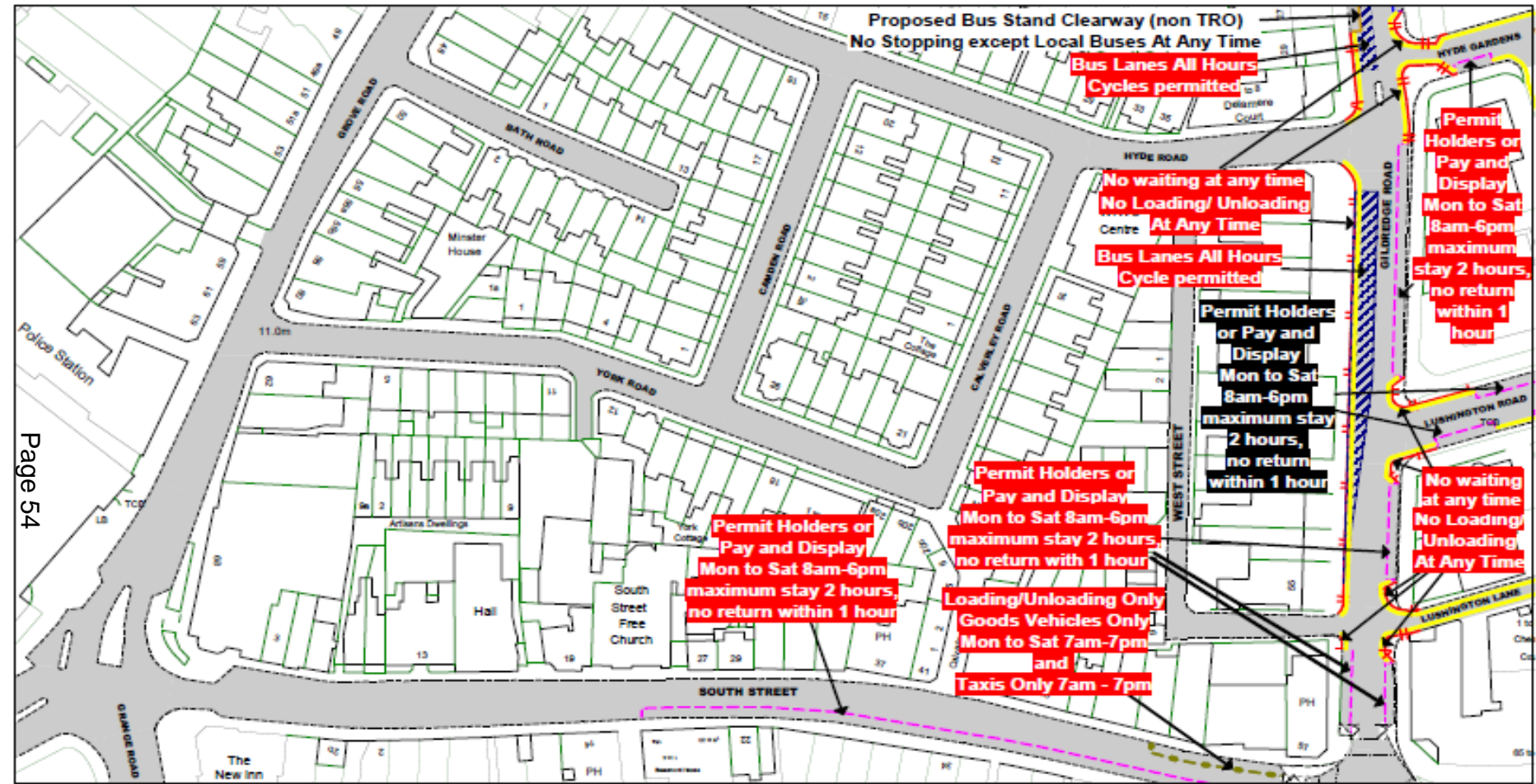

<p>East Sussex County Council</p>	<p>The East Sussex (Eastbourne Town Centre Improvement Scheme) (Parking and Waiting) Order 201x</p>		<p>Key to TRO Restriction Types</p> <ul style="list-style-type: none"> No Waiting at Any Time No Loading at Any Time Permit Holders Only Permit Holder or Pay and Display Disabled Badge Holders Only Disabled Badge Holders Only Loading/ Unloading Only Taxi Only Loading/ Unloading Only and Taxi Only Bus Lane 		<p>Adjacent Map Tile</p> <p>OH176</p> <p>OH175</p> <p>OH177</p> <p>OJ176</p>		<p>Key to Non TRO Items</p> <ul style="list-style-type: none"> Pedestrian Crossing (controlled area) Pedestrian Crossing Point Bus Stop/ Stand Clearway 		<p>© Crown copyright. All rights reserved East Sussex County Council Licence No. 100019801 2017</p>	
	<p>Key to Labels</p> <ul style="list-style-type: none"> ABCD Permanent TRO restriction ABCD Proposed TRO restriction ABCD Non TRO item 						<p>SCALE 1 : 1000</p>		<p>DATE 31/10/2017</p>	
							<p>Tile Ref: OI178</p>		<p>Revision: 0</p>	

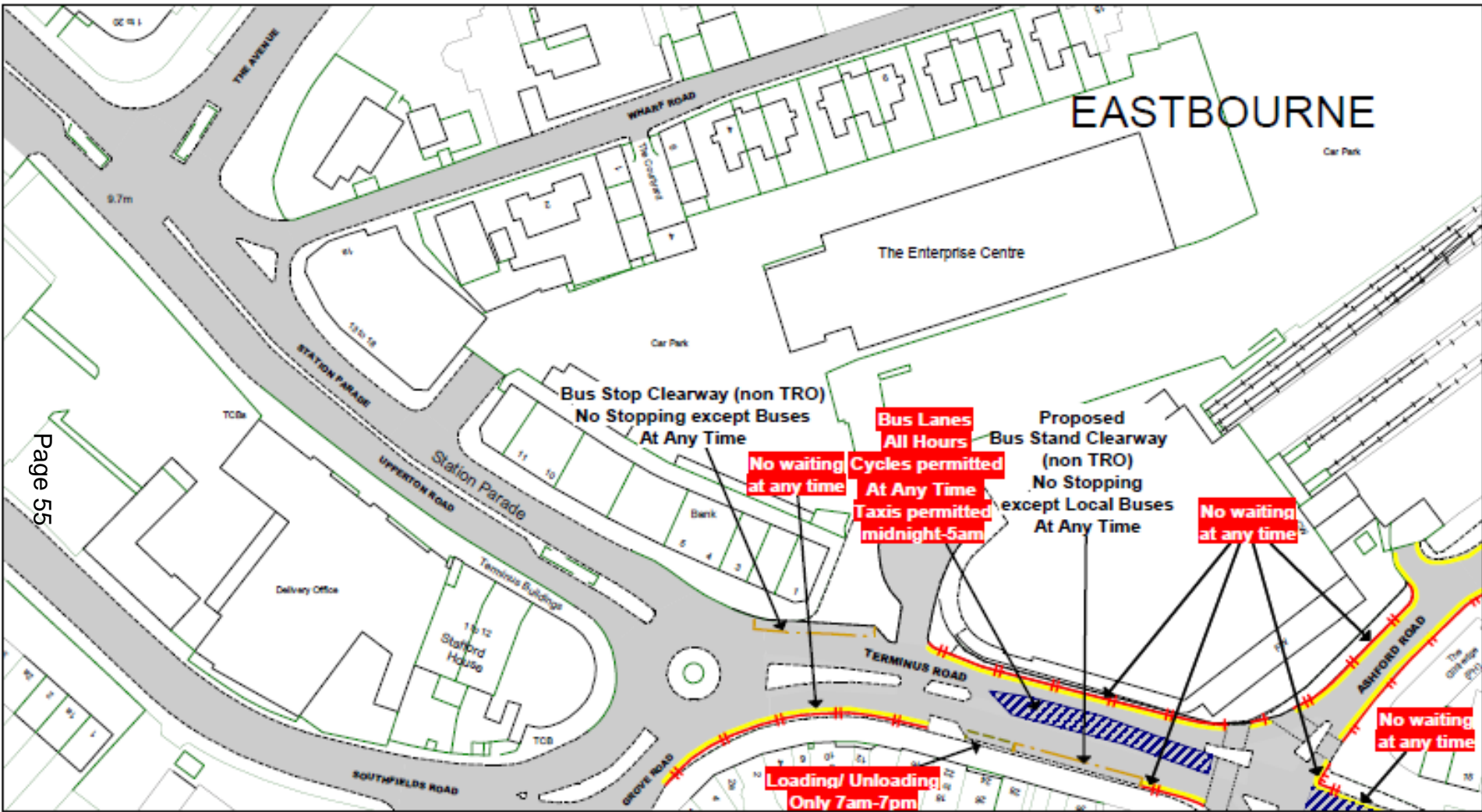

Page 55



**The East Sussex
(Eastbourne Town Centre
Improvement Scheme)
(Parking and Waiting) Order 201x**

Key to Labels

ABCD	Permanent TRO restriction
ABCD	Proposed TRO restriction
ABCD	Non TRO item

Key to TRO Restriction Types

Yellow line	No Waiting at Any Time
Red line with double red bars	No Loading at Any Time
Blue dashed line	Permit Holders Only
Purple dashed line	Permit Holder or Pay and Display
Green dashed line	Disabled Badge Holders Only
Light green dashed line	Disabled Badge Holders Only
Orange dashed line	Loading/ Unloading Only
Black dashed line	Taxi Only

Key to Non TRO Items

Blue hatched box	Loading/ Unloading Only and Taxi Only
Blue hatched box	Bus Lane
Black wavy line	Pedestrian Crossing (controlled area)
Black dashed line	Pedestrian Crossing Point
Yellow dashed line	Bus Stop/ Stand Clearway

Adjacent Map Tile

OF176
OG175
OG177
OH176



© Crown copyright. All rights reserved
East Sussex County Council
Licence No. 100019501 2017

SCALE	1 : 1000
DATE	31/10/2017
Tile Ref: OG176 Revision: 0	

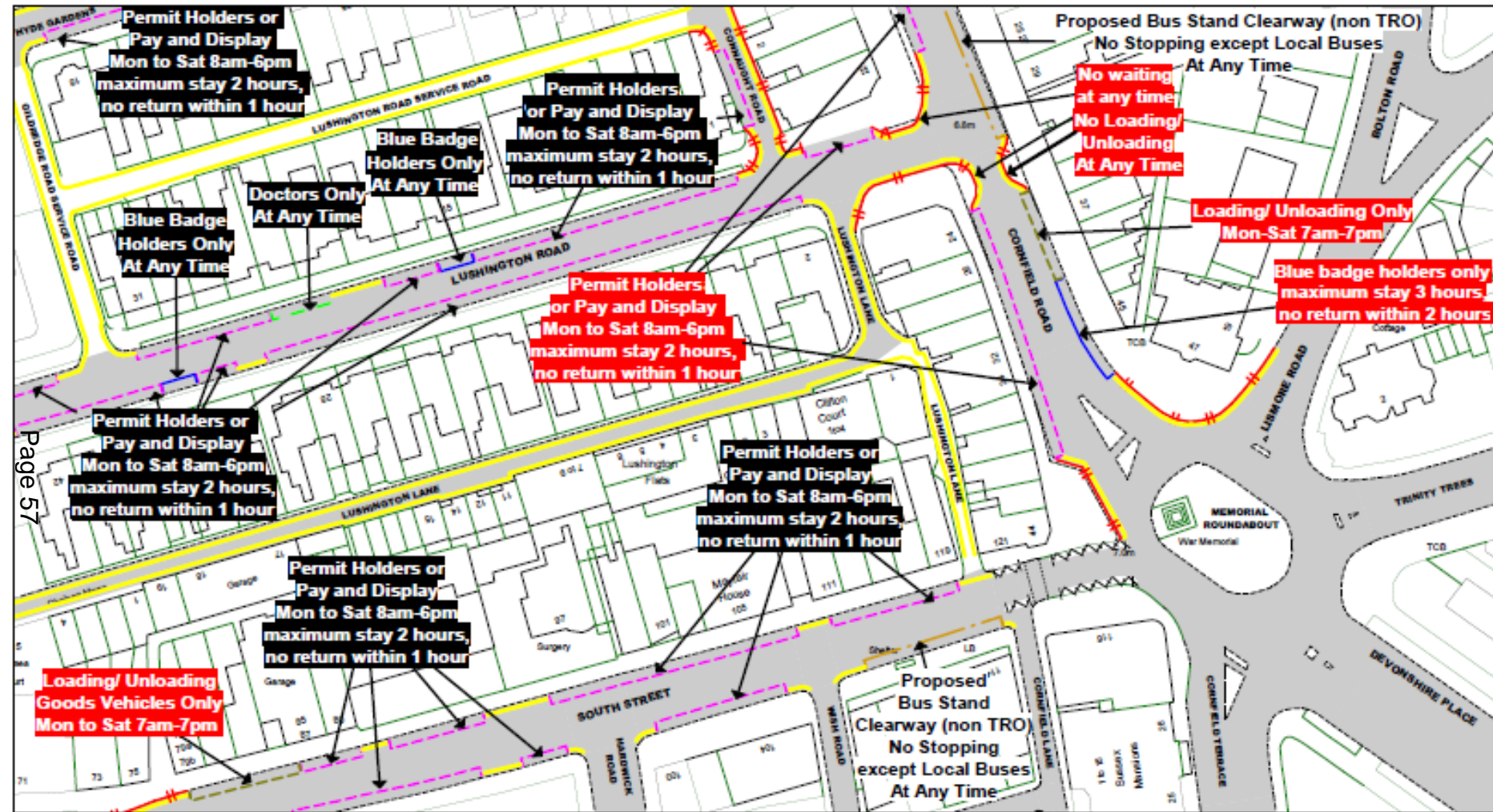

	The East Sussex (Eastbourne Town Centre Improvement Scheme) (Parking and Waiting) Order 201x		Key to TRO Restriction Types		Adjacent Map Tile OH177 OI176 OI178 OJ177		© Crown copyright. All rights reserved East Sussex County Council Licence No. 100019501 2017	
	Key to Labels						Key to Non TRO Items 	1 : 1000
	ABCD Permanent TRO restriction ABCD Proposed TRO restriction ABCD Non TRO item		SCALE	31/10/2017				
			DATE	Tile Ref: OI177 Revision: 0				

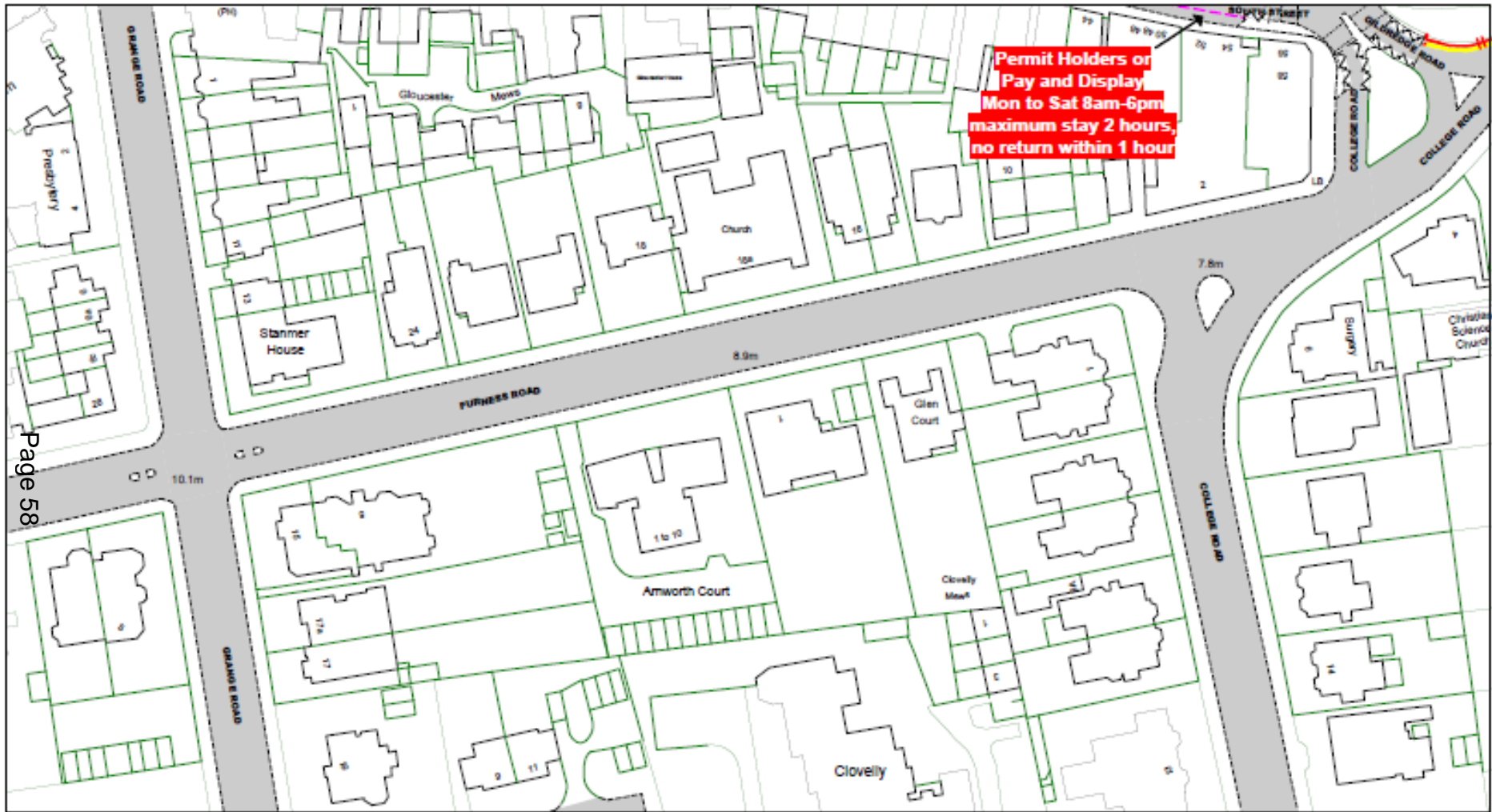

Page 58



The East Sussex
(Eastbourne Town Centre Improvement Scheme)
(Parking and Waiting) Order 201x

Key to Labels

ABCD	Permanent TRO restriction
ABCD	Proposed TRO restriction
ABCD	Non TRO item

Key to TRO Restriction Types

	No Waiting at Any Time		Loading/ Unloading Only and Taxi Only
	No Loading at Any Time		Bus Lane
	Permit Holders Only		
	Permit Holder or Pay and Display		
	Disabled Badge Holders Only		
	Disabled Badge Holders Only		
	Loading/ Unloading Only		
	Taxi Only		

Key to Non TRO Items

	Pedestrian Crossing (controlled area)
	Pedestrian Crossing Point
	Bus Stop/ Stand Clearway

Adjacent Map Tile

O1176
OJ175
OJ177
OK176



SCALE 1 : 1000

DATE 31/10/2017

Tile Ref: OJ176 Revision: 0

© Crown copyright. All rights reserved
East Sussex County Council
Licence No. 100019501 2017

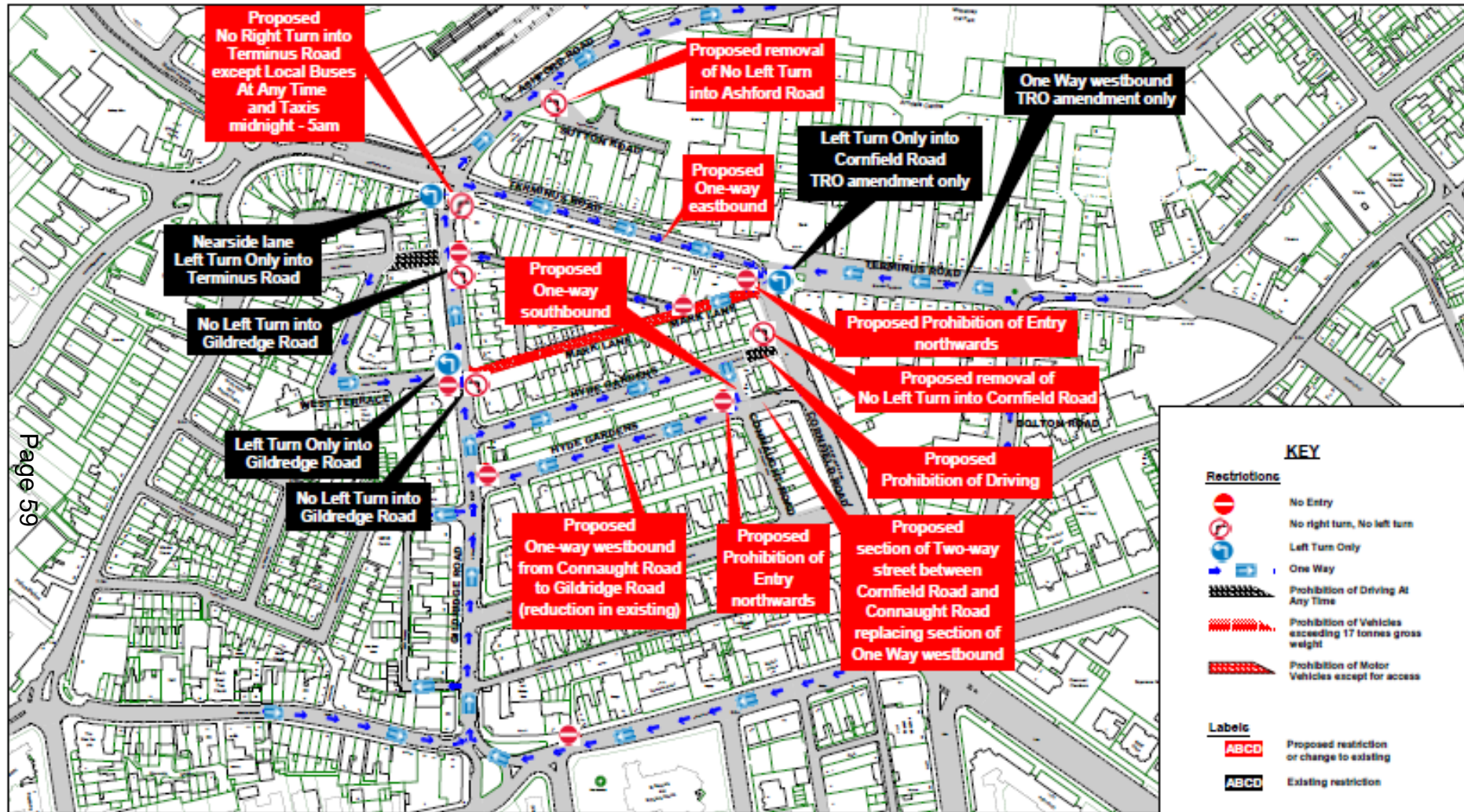

Traffic Regulation Order: Eastbourne Town Centre Improvement Scheme (ETCIS)

Page 60

Proposed 20 MPH zone, bus lanes, parking and prescribed routes to facilitate the implementation of the ETCIS

Traffic Regulation Order: Bexhill Parking Review

Page 61

Proposed new and additional parking restrictions at priority sites in the Bexhill area to address safety concerns that have been raised.



East Sussex
County Council



Bexhill Parking Review
Overview plan of locations objected to

SCALE	1 : 5000
DATE	02/01/2018
DRAWING No.	BPR PC 01
DRAWN BY	

© Crown copyright. All rights reserved
East Sussex County Council
Licence No. 100019601 2017

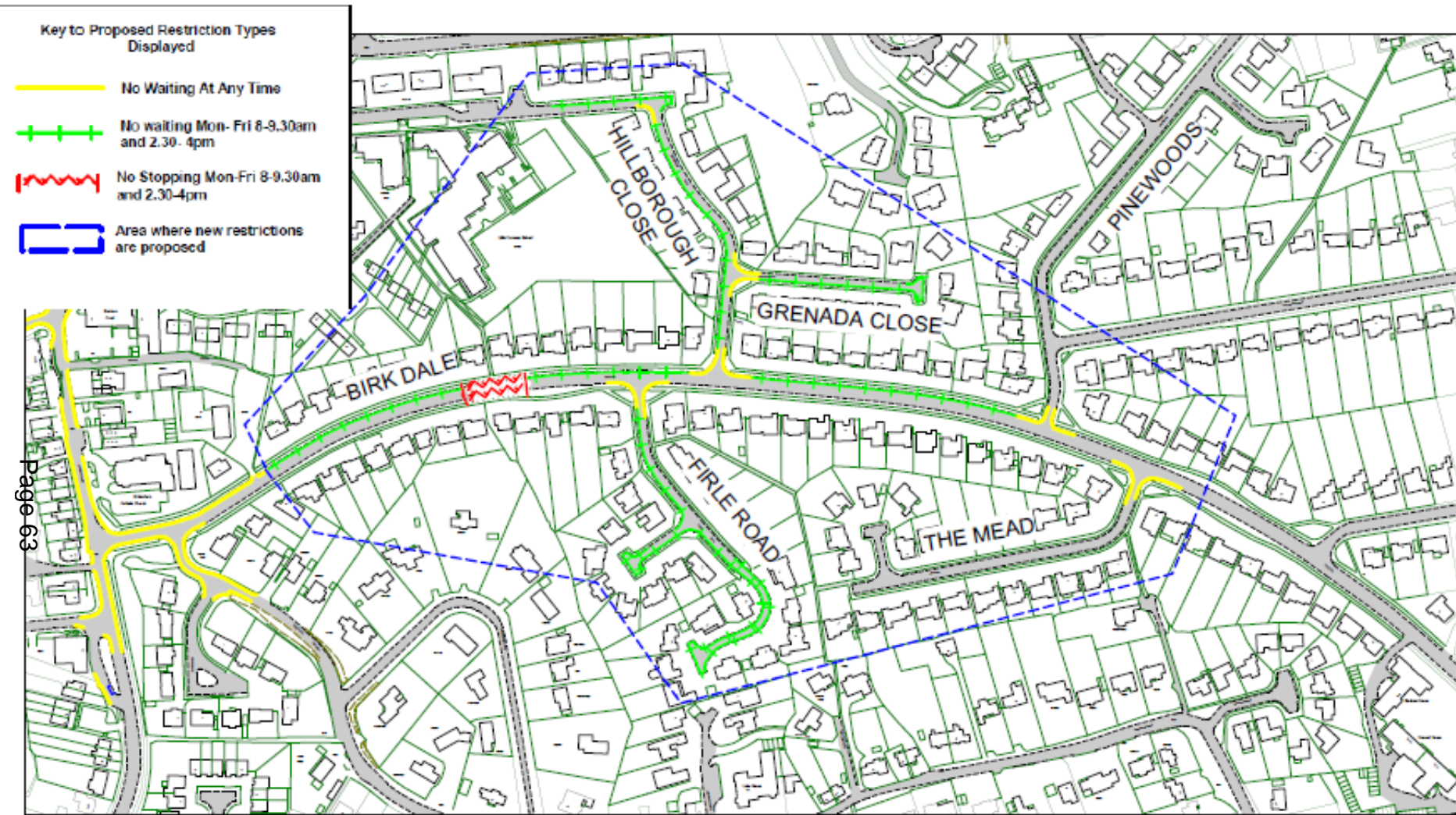



East Sussex
County Council



Bexhill Parking Review 2017 Birk Dale Area etc

Overview Plan of Proposed Restrictions at Birk Dale and Surrounding

SCALE	1 : 3000
DATE	24/07/2017
DRAWING No.	BPR2017 001
DRAWN BY	CSC
© Crown copyright. All rights reserved East Sussex County Council License No. 100019601 2017	

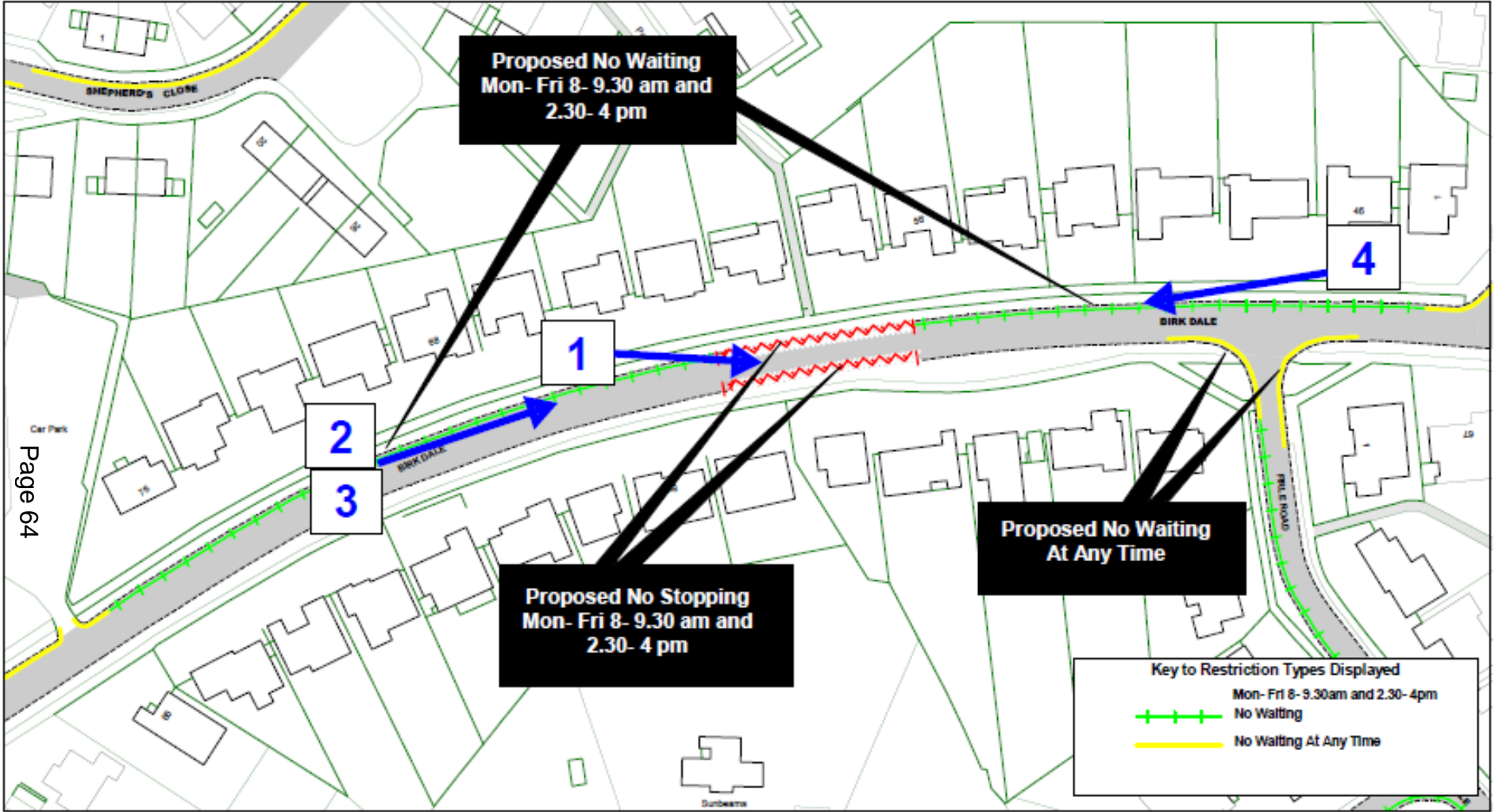



Page 66





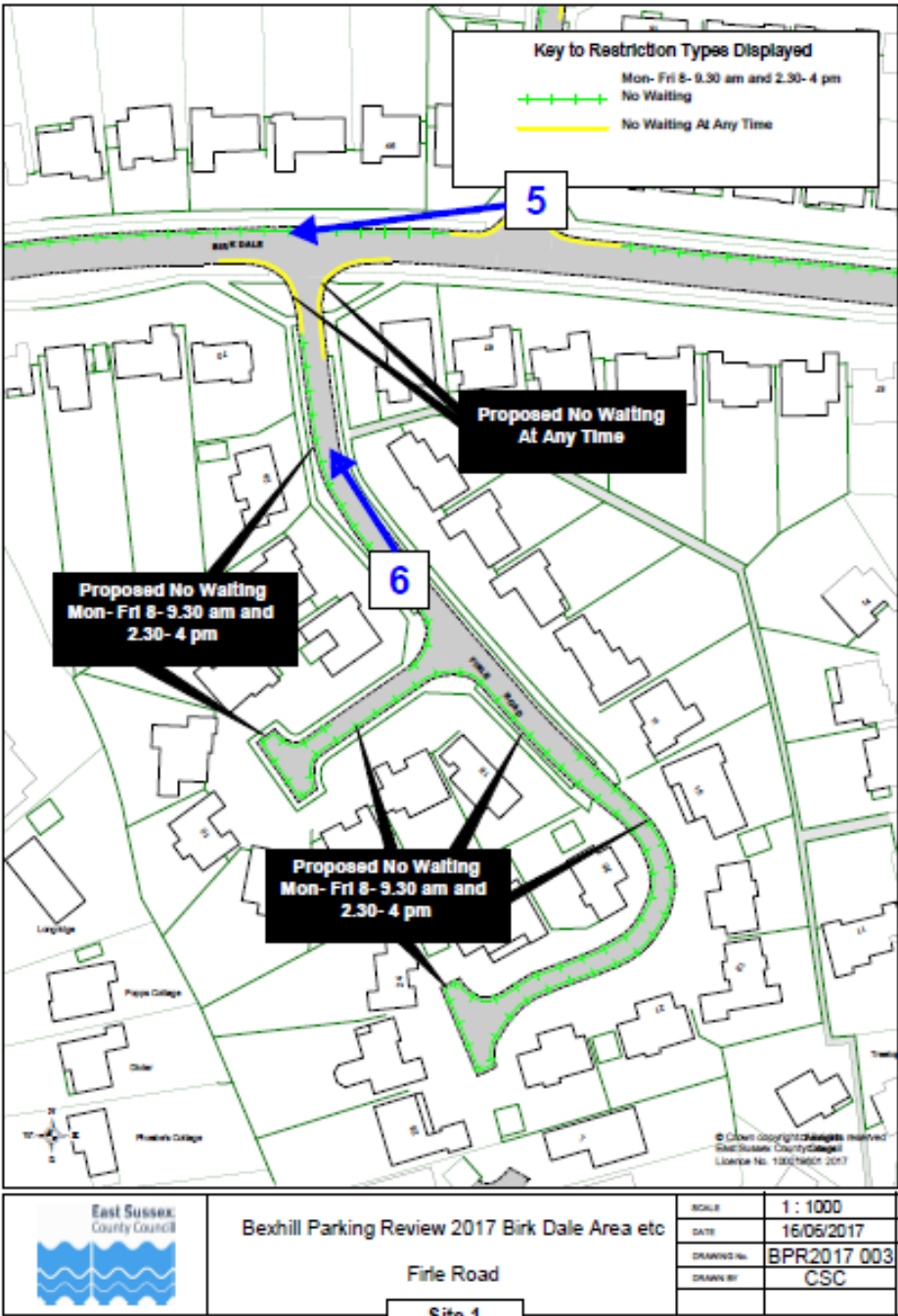





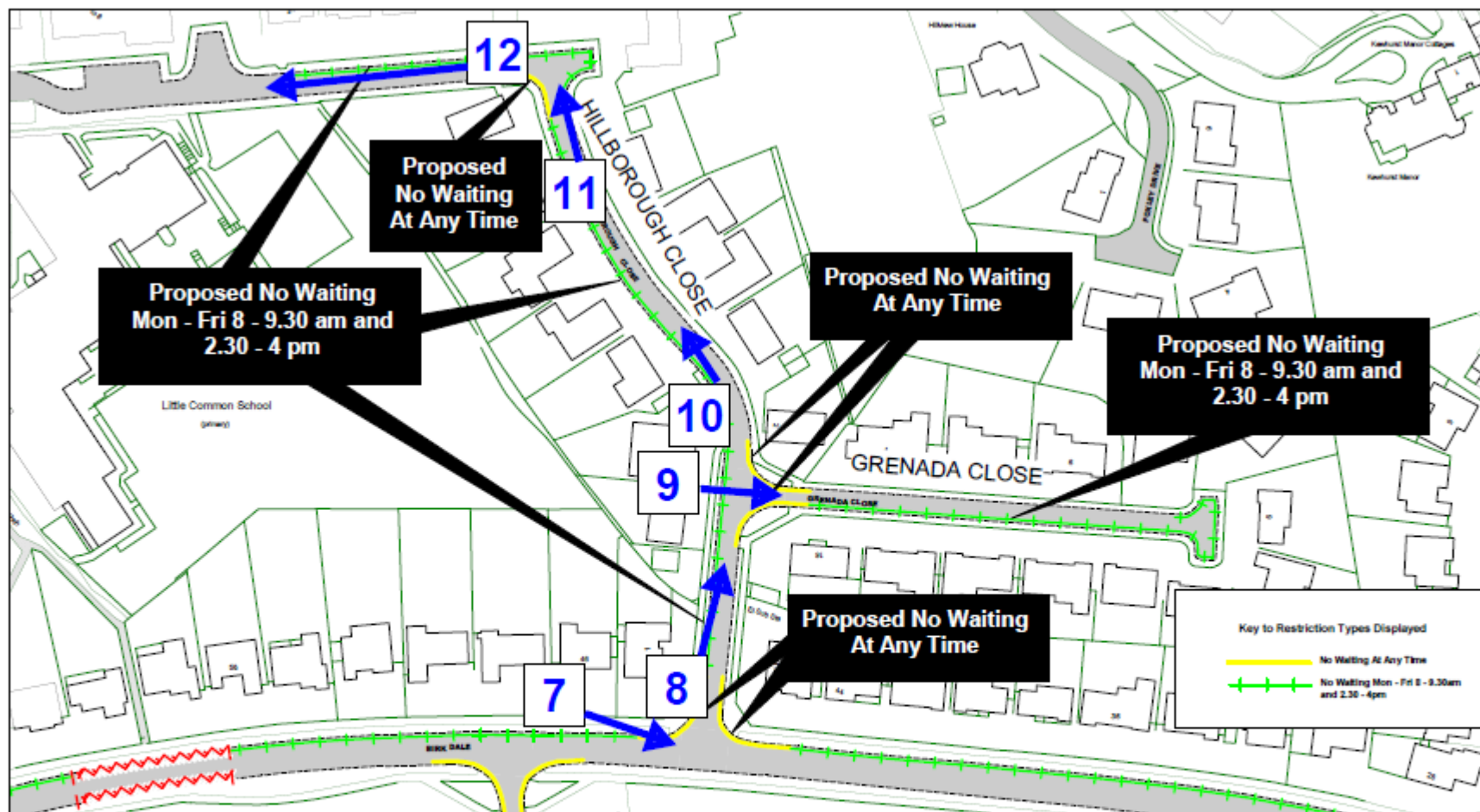



		<p>Bexhill Parking Review 2017 Birk Dale Area etc</p> <p>Hillborough Close and Grenada Close</p> <p>Site 1</p>		SCALE	1 : 1250
				DATE	24/07/2017
				DRAWING No.	BPR2017 004
				DRAWN BY	CSC
				<p>© Crown copyright. All rights reserved East Sussex County Council Licence No. 100019601 2017</p>	

Site 1- Birkdale and surrounding closes













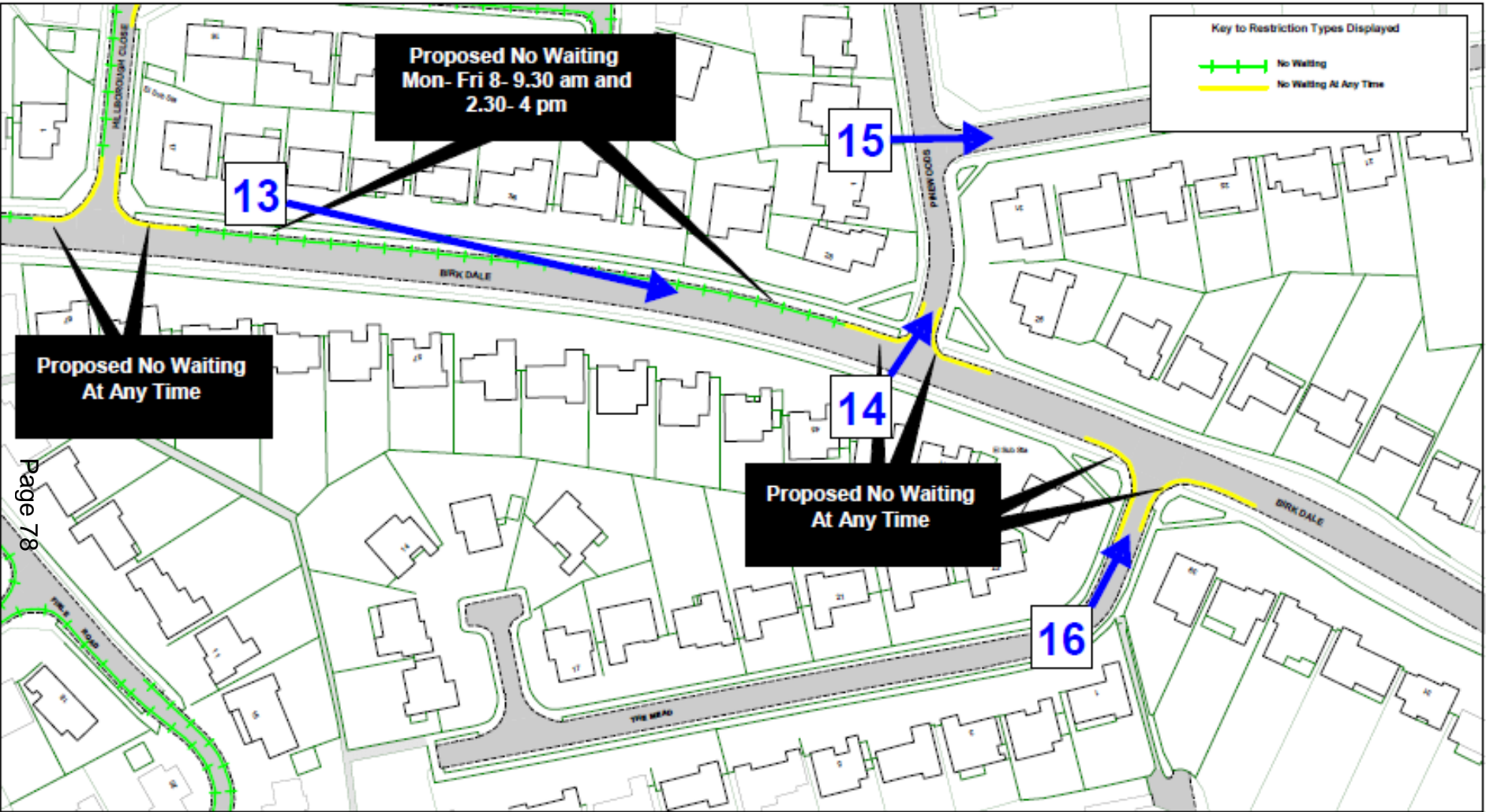

Page 78





Bexhill Parking Review 2017 Birk Dale Area etc

Birk Dale Eastern End

Site 1

SCALE	1 : 1250
DATE	16/06/2017
DRAWING No.	BPR2017 005
DRAWN BY	CSC
© Crown copyright. All rights reserved East Sussex County Council Licence No. 100019601 2017	









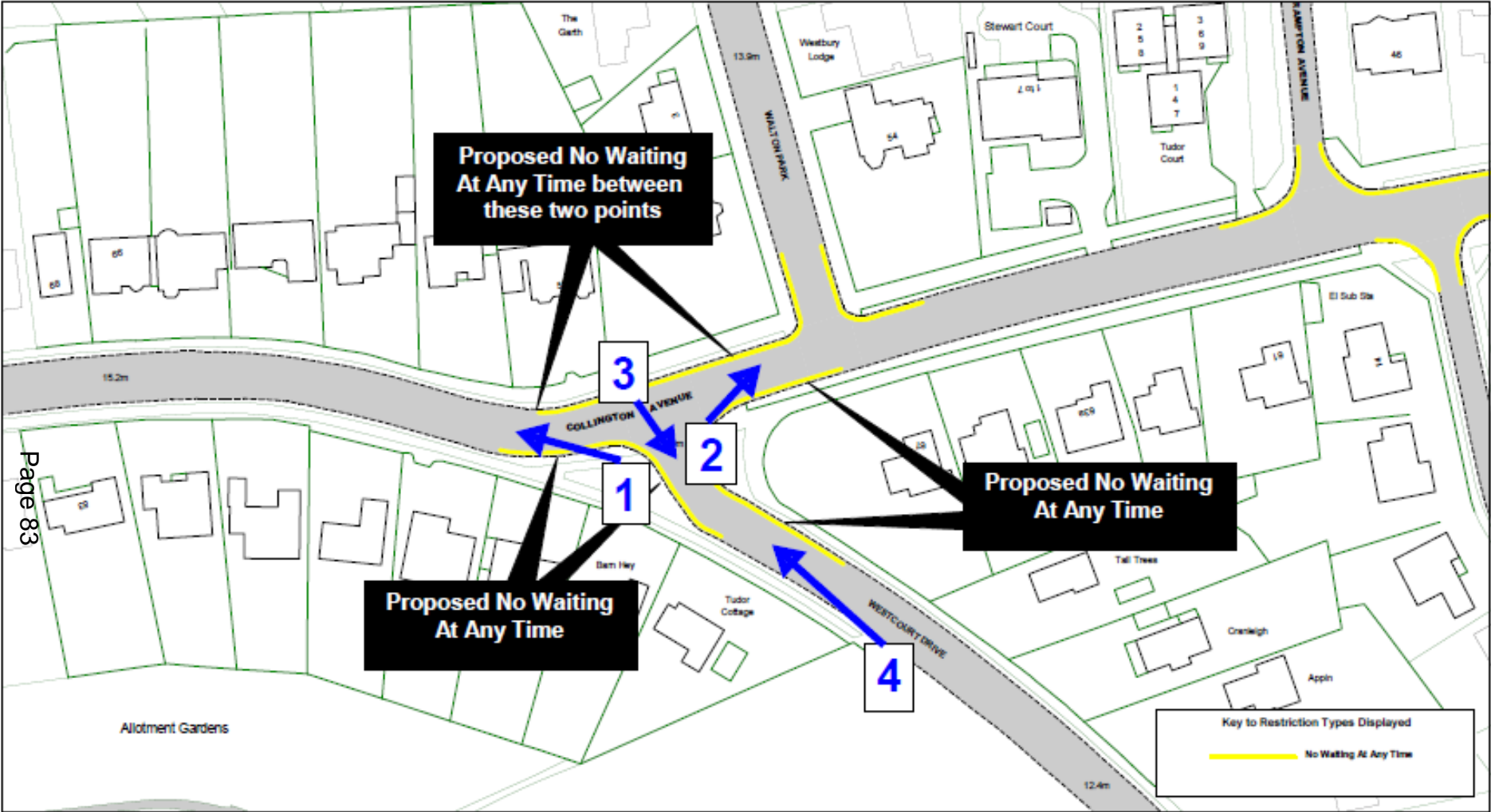





Bexhill Parking Review 2017 Birk Dale Area etc

Collington Avenue and Westcourt Drive

Site 2

SCALE	1 : 1000
DATE	16/06/2017
DRAWING No.	BPR2017 006
DRAWN BY	CSC
	© Crown copyright. All rights reserved East Sussex County Council License No. 100019601 2017









Traffic Regulation Order: Bexhill Parking Review

Page 88

Proposed new and additional parking restrictions at priority sites in the Bexhill area to address safety concerns that have been raised.

East Sussex County Council Planning Committee 14 February 2017

Page 89

This page is intentionally left blank